



RIVA RACING
PERFORMANCE PRODUCTS & ACCESSORIES

160mm Stainless Steel Race Pump

PART# - RY34040-SP-160/12



APPLICATION(S): Yamaha 1.8L FX-SHO/HO, FZR/S & VXR/S models

Required Specialty Tools

Large Hydraulic Press
OEM Service Manual

Part#

N/A
Applicable to your model

This Race Pump must be used with a 160mm pump impeller wear ring and 160mm pump impeller and will match the OEM reduction nozzle as well as the RIVA Pro-Series Reduction Nozzle (part # RY23040-N).

Installation of this RIVA Performance Product should be done only by an experienced professional with proper shop tools. The steps outlined in the 'JET PUMP – Impeller Duct and Drive Shaft' section of your OEM service manual must be followed and strictly adhered to. Information on the following page is provided as a guide and intended to complement the OEM service manual.

It is critical that the proper grease type and volume be used when reassembling this Race Pump and that new drive shaft seals and bearings are installed. Failure to do so could result in damage to the pump components and is not covered under warranty. To order new drive shaft seals and bearings please refer to our Online Original Parts Finder at www.rivaracing.com/parts or contact our Parts Specialists at (800) 241-4544, (954) 785-2684 or orders@rivamotorsports.com.

- INSTALLATION GUIDE -

After disassembling stock pump you are required to replace the stock pump seals and drive shaft bearings per the OEM Service Manual.

When installing seals and impeller spacer ensure they are facing the proper direction and installed completely.

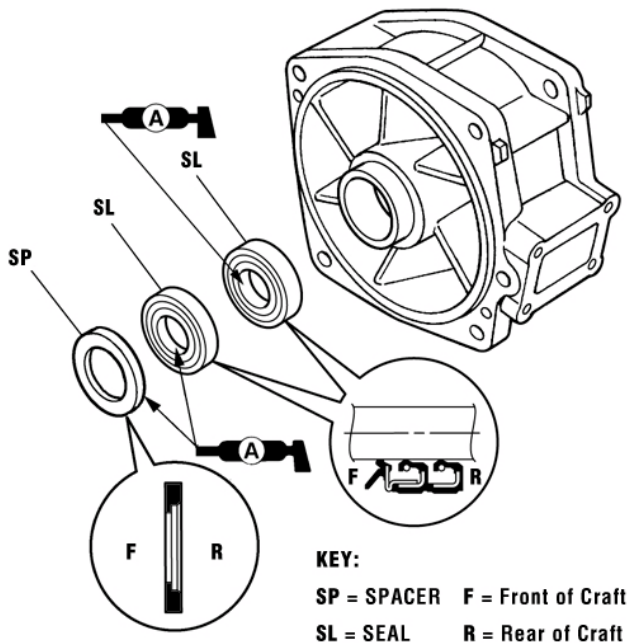

Required Pump Components:

Drive Shaft Seals

Refer to Online Original Parts Finder

Drive Shaft Bearings

Refer to Online Original Parts Finder

160mm Impeller Wear Ring

RIVA Part # RY33-160-YF-1

160mm Pump Impeller

Recommended Pump Components:

Pro-Series Reduction Nozzle

RIVA Part # RY23040-N

***Remember, the water belongs to everyone.
Please ride responsibly and respect the environment!***

Technical Support

For answers to questions regarding installation or trouble shooting RIVA Performance Products contact: RIVA Technical Support directly at (954) 247-0705 or by e-mail at tech_support@rivamotorsports.com.

Limited Warranty

RIVA Stainless Steel Race Pumps carry a 90-day limited warranty to the original purchaser. They are warranted to be free of defects in materials and workmanship under normal use and service. Customer modified components will be void of warranty. This warranty is limited to defects in the primary components only. Finish and/or wear marks in or on primary components are not covered under this warranty.

RIVA Racing's liability is expressly limited to the repair or replacement of the components contained within or associated with this kit. RIVA Racing agrees to repair or at RIVA's option, replace any defective unit without charge, if product is returned to RIVA Racing freight prepaid within the warranty period. Any equipment returned which, in RIVA's opinion, has been subjected to misuse, abuse, overheating or accident shall not be covered by this warranty.

RIVA Racing shall have no liability for special, incidental or consequential damages or injury to persons or property from any cause arising from the sale, installation or use of this product.

No other warranty, express or implied, including, but not limited to the implied warranties of merchantability and fitness for a particular purpose, applies. Various states do not allow for the limitation of incidental or consequential damages and therefore the above exclusion or limitation may not apply to you.

Warranty does not include the expenses related to freight or transportation of parts or compensation for any inconvenience or loss of use while being repaired. A copy of the original invoice and a Return Authorization Number (RA#) must accompany all warranty claims.

Warranted replacement parts will be returned freight collect.